

Read this instruction carefully. See hardware and furniture part list for guidance. Be sure all part is complete, before you assemble. Place all wooden furniture part on a clean and flat soft surface to prevent from being scratched. Follow the figure to start assembling.

CAUTIONS :

- 1. Do not FULLY-TIGHTEN the nut or nut bolt until all nut or bolt is ready assembled.
- 2. Do not OVER-TIGHTEN the nut or nut bolt to avoid causing damages to the thread.
- 3. Keep all hardware part out of reach of children.

PART LIST			HARWARE LIST		
ITEM	DESCRIPTION	QTY	ITEM	DESCRIPTION	QTY
A	CAP REAR	1 PC	1	JCBC SCREW M6 x 60MM 	4 PCS
B	SIDE PANEL (L & R)	2 PCS	2	SPRING WASHER 1/4" 	4 PCS
C	WOODEN SEAT	1 PC	3	ALLEN KEY (M4 BALL SHAPE) LONG 	1 PC
			4	CSK SCREW #8 x 32MM 	1 PC
			5	CSK SCREW M4 x 25MM 	4 PCS
			6	Wood Button Ø14.5 x 9mm 	4 PCS

Step 1 :

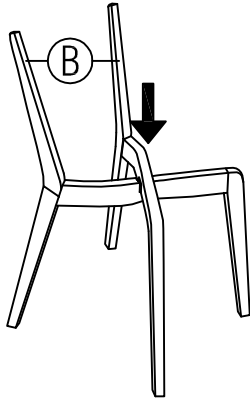

Step 2 :

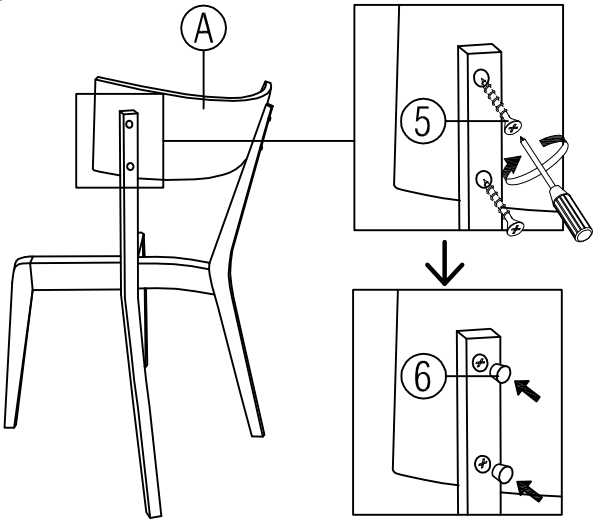

Step 3 :

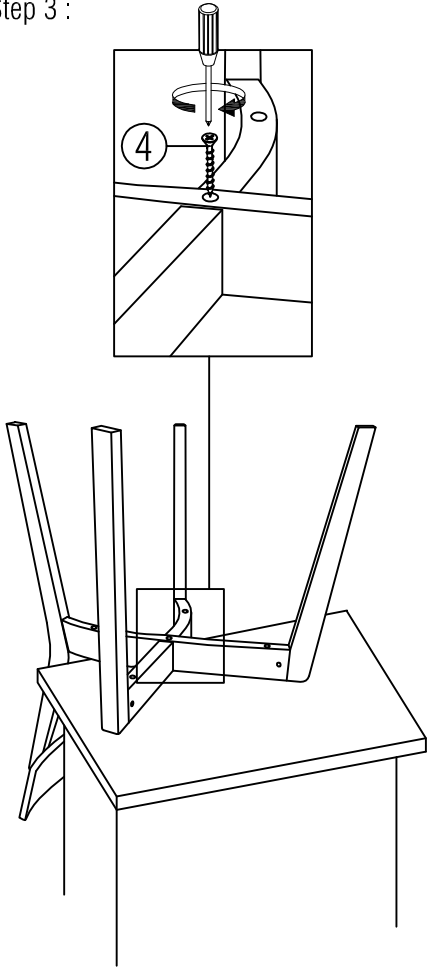

Step 4 :

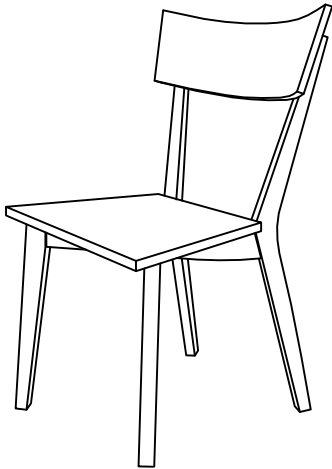
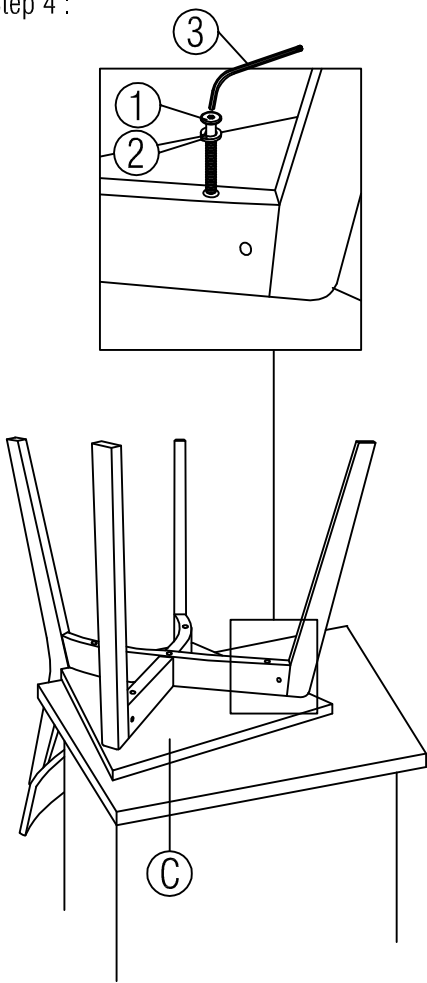

COMPLETED CHAIR ASSEMBLY