

# COMET/GRAVITY

sofa

**Insert the screw into the metal bracket (in accordance with the sequence 1;2;3;4). Then tighten the screw to a depth of approx. 10 mm. Then screw the bolts (screw gradually), keeping attention not to damage the surface of leg.**

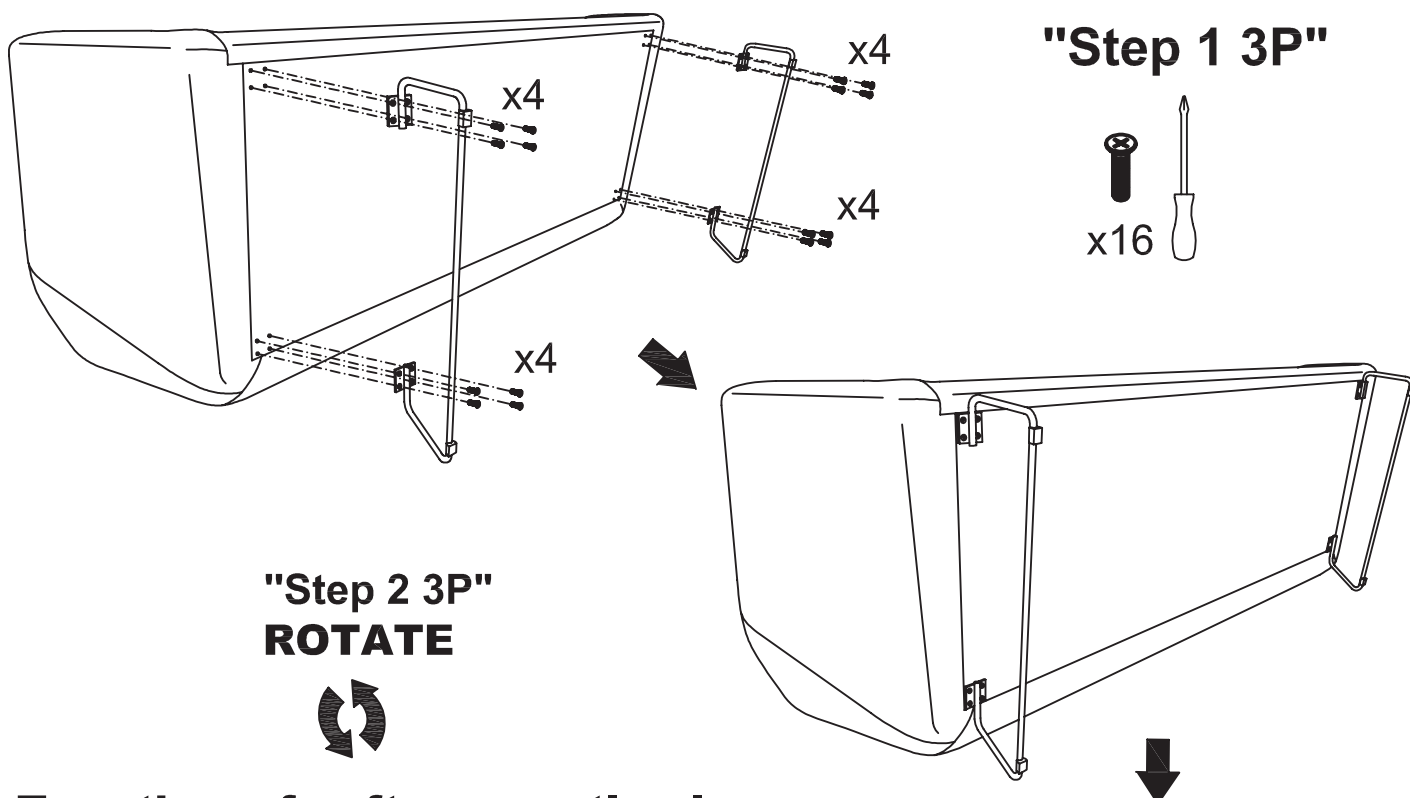

**Turn the sofa after mounting legs.  
By using at least two persons.**

